

DOOR UPGRADES

Promat SUPALUX® and MASTERBOARD® boards provide a quick and economical method of upgrading existing latched single leaf, single acting flush and panelled timber doors to achieve 20 minutes fire integrity – FD20.

For use, for example, where required by alterations to a building, change of use, or under certification requirements of the Fire Precautions Act.

Promat products are robust, and their use eliminates the task of installing a new door and frame. They are particularly good for high quality panelled doors and it is possible to retain the original character and panelled appearance whilst achieving fire resistance.

The upgrading specifications described in this document have been fully tested or assessed by recognised independent authorities. They can be used to meet the relevant requirements of Building Regulations and the Fire Precautions Act.

In relation to the latter, upgrading can be used in hotels and boarding houses as well as conversion to multiple occupancy housing.

Supalux is a non-combustible board and Masterboard is a material of limited combustibility. Both products are equally suited to door upgrade applications.

DESIGN

Sealing the Leaf/ Frame Gap

In order for a doorset to achieve its required performance, an intumescent seal must be fitted across the head and down both jambs. The seals may be fitted either centrally in the leaf edge or centrally in the frame reveal opposite the leaf edge.

Where the leaf is being removed for upgrading work, it may be easier to fit the intumescent seal into the leaf edges.

An intumescent seal will activate to fill the gap between the leaf edge and the frame when fire breaks out. Intumescent seals alone are not designed to offer any resistance to cold smoke but, when activated, are effective barriers to hot smoke, flames and hot gases.

Smoke control can be achieved by the use of a proprietary smoke seal brush or blade, fitted into the leaf edges, or with combined intumescent/smoke seals that have been tested in accordance with BS 476: Section 31.1: 1983.

Frame Construction

This upgrade does not apply to doors leaves fitted into metal frames.

The door leaves should be hung in a doorframe of minimum dimensions 70mm x 32mm. The leaf to frame gaps must be controlled to a maximum of 4mm. Similarly, the threshold gap should be controlled to a maximum of 10mm. The doorframe to structural opening gap must also be protected with suitable materials.

The doorframe to structural opening gap must be suitably firestopped, and the doorset securely fastened to the surround.

It is not necessary for doorstops to be machined from the solid, a pinned and glued or screwed and glued stop is equally satisfactory. Doorstops must be a minimum 12mm deep. The density of timber used for constructing the leaf and doorframe must be in excess of 480kg/m³, and may be softwood or hardwood.

Existing door hardware cannot be assumed to be suitable for use on a fire resisting door, or assumed to be sufficiently well fitted.

Leaves must be hung on *three* brass or steel butt hinges of blade sizes as follows:

- 100mm high x 32mm to 35mm x 3mm thick blade for 44mm thick leaves.
- 100mm high x 25mm to 30mm x 3mm thick blade for 38mm to 43mm thick leaves.
- 100mm high x 20mm to 24mm x 3mm thick blade for 32mm to 37mm thick leaves.

The full width of the hinge blade must be fitted within the leaf edge/frame reveal.

The doorset must be fitted with a type of face-fixed automatic closing device and a latch/lock assembly, that have demonstrated their capability of maintaining integrity for the required period in similar doorset designs, when tested to the current standard. Concealed overhead closures are not suitable unless specifically proven by test.

Care of the Door Leaf

Any gaps greater than 2mm between the stiles, rails and muntins must be filled over with Promat Intumescent Sealant. The top and bottom mortise and tenon junctions must be additionally fixed with a 10mm softwood dowel, glued into position with a urea formaldehyde adhesive.

Method 1: (Fire from Either Side)

Original Door: Flush timber door, with minimum 35mm thick leaf and minimum 3mm hardboard facings.

Maximum leaf size 1981mm x 762mm

Increase leaf sizes are permitted for flush doors with minimum 40mm leaf thickness, as follows:

From: Maximum leaf size 1981mm x 838mm
To: Maximum leaf size 2032mm x 813mm

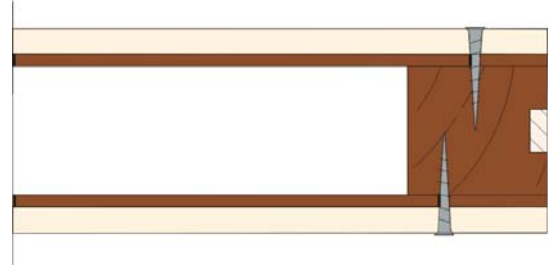

Panels: 6mm SUPALUX® or 6mm MASTERBOARD® fixed with 32mm x No. 8 steel screws around the perimeter of the leaf, at 150mm centres.

Intumescent Strip: 10mm x 4mm PVC encased Palusol 100 strip to both vertical edges and top of the door.

Door Stop: Minimum 12mm deep

Note: This upgrade cannot be applied *in-situ*. The doorstop must be repositioned, and the door re-hung, flush with the frame.

Method 2: (Fire from Either Side)

Original Door: Timber panelled door, with minimum 35mm thick leaf and minimum 4mm timber panels.

Maximum leaf size 1981mm x 762mm

Increase leaf sizes are permitted for flush doors with minimum 40mm leaf thickness, as follows:

From: Maximum leaf size 1981mm x 838mm
To: Maximum leaf size 2032mm x 813mm

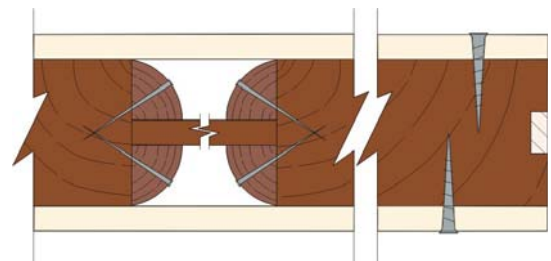

Panels: 6mm SUPALUX® or 6mm MASTERBOARD® fixed with 32mm x No. 8 steel screws around the perimeter of the leaf, at 150mm centres.

Intumescent Strip: 10mm x 4mm PVC encased Palusol 100 strip to both vertical edges and top of the door.

Door Stop: Minimum 12mm deep

Note: This upgrade may be applied *in-situ*, and does not require the doorstop to be repositioned, or the door re-hung.

AUTHORITY: Chiltern International Fire Assessment report number: FEA/F98048

Technical Data Sheet – 005

Page 2 of 5
(Jan 2004)



Promat UK Limited
Technical Service Department
The Sterling Centre, Eastern Road
Bracknell, Berkshire RG12 2TD
Tel: 01344 381 400
Fax: 01344 381 401
E-mail: technicaluk@promat.co.uk



Method 3: (Fire from One Side Only - Promat Panel on Exposed Face)

Original Door: Timber panelled door, with 35mm thick leaf, and minimum 4mm timber panels. Maximum door leaf sizes as follows:

From: Maximum leaf size 1981mm x 817mm
To: Maximum leaf size 2130mm x 762mm

Increased leaf sizes are permitted for panelled doors with minimum 36mm leaf thickness as follows:

From: Maximum leaf size 1981mm x 838mm
To: Maximum leaf size 2032mm x 813mm

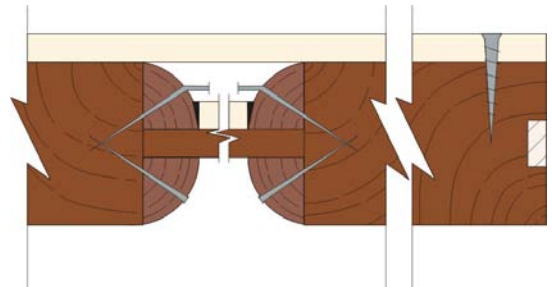

Infill Panels: 6mm SUPALUX® or 6mm MASTERBOARD® retained between the 11mm hardwood quadrant beads with 32mm long steel pins at 200mm centres with the top 10mm bent back over the face of the board. Sealed to bead edges with Promaseal Intumescent Sealant.

Facing Panel: 6mm SUPALUX® or 6mm MASTERBOARD® fixed with 32mm x No. 8 steel screws around the perimeter of the leaf and across the mid-rail only at 150mm centres.

Intumescent Strip: 10mm x 4mm PVC encased Palusol 100 strip to both vertical edges and top of the door.

Door Stop: Minimum 12mm deep

Note: This upgrade may be applied *in-situ*, and does not require the doorstop to be repositioned, or the door re-hung.

Method 4: (Fire from Either Side)

Original Door: Timber panelled door, with minimum 33mm thick leaf. Maximum door leaf sizes as follows:

From: Maximum leaf size 2000mm x 897mm
To: Maximum leaf size 2200mm x 815mm

Panels: 12mm SUPALUX® or 12mm MASTERBOARD® faced (with or without 0.9mm veneers to both faces, bonded with PVA adhesive), set in Promaseal Intumescent Sealant and held in place with 11mm hardwood quadrant beads skew nailed with 32mm steel pins at 200mm centres.

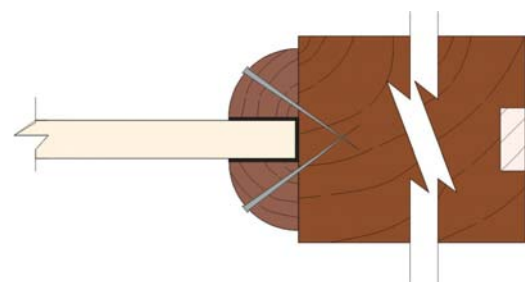

Intumescent Strip: 10mm x 4mm PVC encased Palusol 100 strip to both vertical edges and top of the door.

Door Stop: Minimum 12mm deep

AUTHORITY: Chiltern International Fire Assessment report number: FEA/F98048

Technical Data Sheet – 005

Page 3 of 5
(Jan 2004)



Promat UK Limited
Technical Service Department
The Sterling Centre, Eastern Road
Bracknell, Berkshire RG12 2TD
Tel: 01344 381 400
Fax: 01344 381 401
E-mail: technicaluk@promat.co.uk



Method 5: (Fire from Either Side)

- Original Door:** Timber panelled door, with minimum 33mm thick leaf. Maximum door leaf sizes as follows:
From: Maximum leaf size 2000mm x 897mm
To: Maximum leaf size 2200mm x 815mm
- Panels:** 6mm SUPALUX® or 6mm MASTERBOARD® with 3mm thick hardwood ply facings, (bonding to the Promat board is not necessary), set in Promaseal Intumescent Sealant and held in place with 11mm hardwood quadrant beads skew nailed with 32mm steel pins at 200mm centres.
- Intumescent Strip:** 10mm x 4mm PVC encased Palusol 100 strip to both vertical edges and top of the door.
- Door Stop:** Minimum 12mm deep.

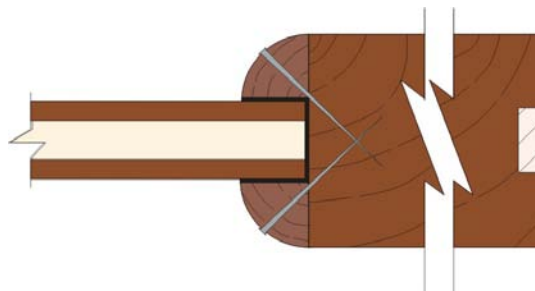

Method 6: (Fire from One Side Only – Promat board on Unexposed Face)

- Original Door:** Timber panelled door, with minimum 33mm thick leaf, and minimum 6mm thick softwood panels. Maximum door leaf sizes as follows:
From: Maximum leaf size 2000mm x 897mm
To: Maximum leaf size 2200mm x 815mm
- Panels:** 6mm SUPALUX® or 6mm MASTERBOARD® (with or without 0.9mm thick veneers bonded to both faces with PVA adhesive), set in Promaseal Intumescent Sealant and held in place with 11mm hardwood quadrant beads skew nailed with 32mm steel pins at 200mm centres.
- Intumescent Strip:** 10mm x 4mm PVC encased Palusol 100 strip to both vertical edges and top of the door.
- Door Stop:** Minimum 12mm deep.

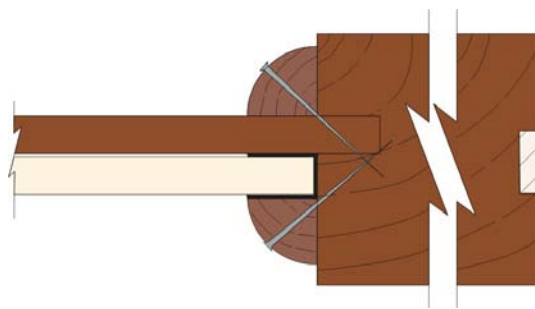

Method 7: (Fire from One Side Only – Promat board on Unexposed Face)

- Original Door:** Timber panelled door, with minimum 33mm thick leaf, with softwood raised and fielded facings - minimum 6mm thick at the fielding. Maximum door leaf sizes as follows:
From: Maximum leaf size 2000mm x 897mm
To: Maximum leaf size 2200mm x 815mm
- Panels:** 6mm SUPALUX® or 6mm MASTERBOARD® (veneer not permitted), set in Promaseal Intumescent Sealant and held in place with 11mm hardwood quadrant beads skew nailed with 32mm steel pins at 200mm centres.
- Intumescent Strip:** 10mm x 4mm PVC encased Palusol 100 strip to both vertical edges and top of the door.
- Door Stop:** Minimum 12mm deep.

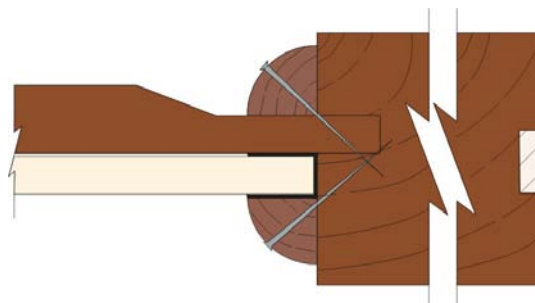

AUTHORITY: Chiltern International Fire Assessment report number: FEA/F98048

Technical Data Sheet – 005

Page 4 of 5
(Jan 2004)



Promat UK Limited
Technical Service Department
The Sterling Centre, Eastern Road
Bracknell, Berkshire RG12 2TD
Tel: 01344 381 400
Fax: 01344 381 401
E-mail: technicaluk@promat.co.uk



Method 8: (Fire from Either Side)

- Original Door:** Timber panelled door, with minimum 40mm thick leaf. Maximum door leaf sizes as follows:
From: Maximum leaf size 2000mm x 951mm
To: Maximum leaf size 2333mm x 815mm
- Panels:** 6mm SUPALUX® or 6mm MASTERBOARD® with 4mm plywood facings or softwood raised and fielded panels (minimum 4mm at the fielding), (bonding to the Promat board is not necessary), set in Promaseal Intumescent Sealant and held in place with 11mm hardwood quadrant beads skew nailed with 32mm steel pins at 200mm centres.
- Intumescent Strip:** 10mm x 4mm PVC encased Palusol 100 strip to both vertical edges and top of the door.
- Door Stop:** Minimum 12mm deep.

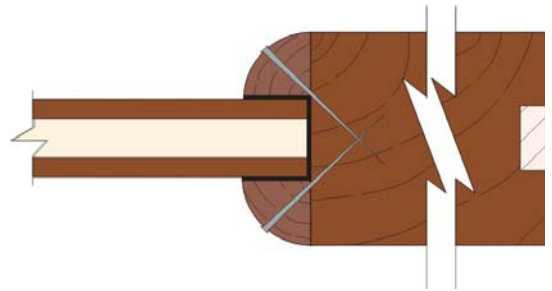

Method 9: (Fire from One Side Only – Promat board on Unexposed Face)

- Original Door:** Timber panelled door, with minimum 40mm thick leaf, and minimum 6mm thick softwood panels. Maximum door leaf sizes as follows:
From: Maximum leaf size 2000mm x 951mm
To: Maximum leaf size 2333mm x 815mm
- Panels:** 6mm SUPALUX® (with or without 0.7mm thick veneers bonded to both faces with PVA adhesive), set in Promaseal Intumescent Sealant and held in place with 11mm hardwood quadrant beads skew nailed with 32mm steel pins at 200mm centres.
- Intumescent Strip:** 10mm x 4mm PVC encased Palusol 100 strip to both vertical edges and top of the door.
- Door Stop:** Minimum 12mm deep.

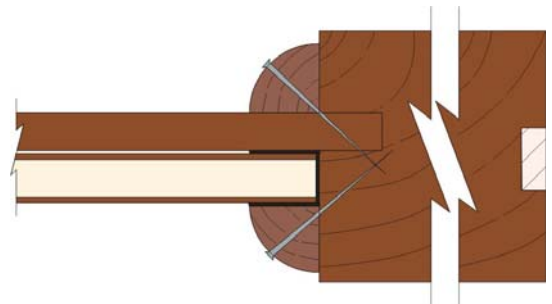

Method 10: (Fire from One Side Only – Promat board on Exposed Face)

- Original Door:** Timber panelled door, with minimum 40mm thick leaf, and minimum 6mm thick softwood panels. Maximum door leaf sizes as follows:
From: Maximum leaf size 2000mm x 951mm
To: Maximum leaf size 2333mm x 815mm
- Panels:** 9mm SUPALUX® or 9mm MASTERBOARD® (with or without 0.7mm thick veneers bonded to both faces with PVA adhesive), set in Promaseal Intumescent Sealant and held in place with 11mm hardwood quadrant beads skew nailed with 32mm steel pins at 200mm centres.
- Intumescent Strip:** 10mm x 4mm PVC encased Palusol 100 strip to both vertical edges and top of the door.
- Door Stop:** Minimum 12mm deep.

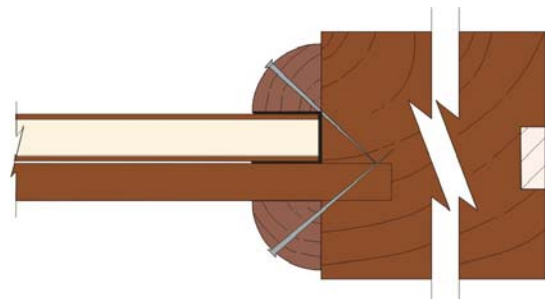

AUTHORITY: Chiltern International Fire Assessment report number: FEA/F98048

Technical Data Sheet – 005

Page 5 of 5
(Jan 2004)



Promat UK Limited
 Technical Service Department
 The Sterling Centre, Eastern Road
 Bracknell, Berkshire RG12 2TD
 Tel: 01344 381 400
 Fax: 01344 381 401
 E-mail: technicaluk@promat.co.uk

