

Detail 1 – Elevation (within Promat SYSTEMGLASS® screen).

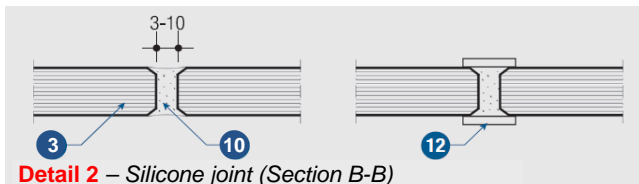

Detail 2 – Silicone joint (Section B-B)

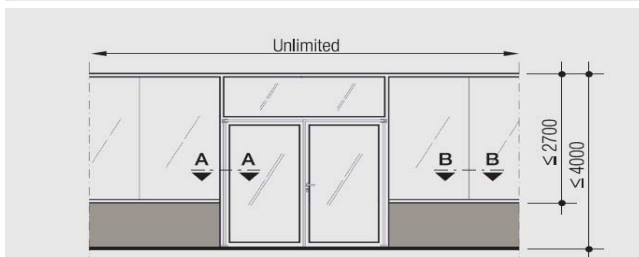

Detail 3 – Elevation (within partly glazed masonry wall).

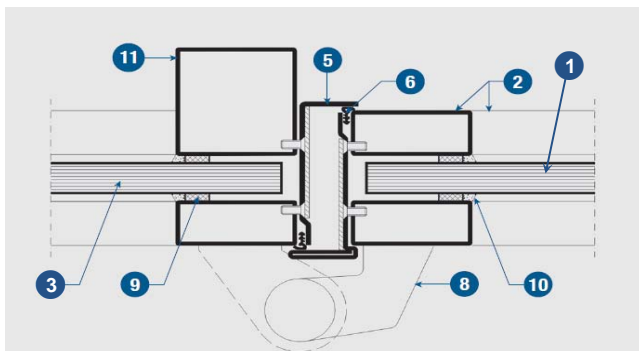

Detail 4 – Door leaf and frame detail (Section A-A).

NOTE 1: Under no circumstances should the edging tape be removed from the glass. It is there to prevent ingress of moisture or acetate from the silicone sealant entering the intumescent layer and causing discolouration.

NOTE 2: Promat SYSTEMGLASS® is designed for use in internal applications. It should not be used in high humidity, semi exposed or external applications.

NOTE 3: For SYSTEMGLASS® all glass screens refer to TDS122 and TDS123 (August 2011).

NOTE 4: Refer to TDS121 (August 2011) for more details on the Promat SYSTEMGLASS® system.

Promat SYSTEMGLASS® Single & Double Leaf Fire Doors: - Within All Glass Screens.

Promat SYSTEMGLASS® T-doors are constructed without any visible glazing beads on the retaining frame and it can be built as single or double leaf door in a Promat SYSTEMGLASS® screen element. A choice of floor or head mounted closers can be proposed as well as their selected hardware.

30 and 60 minutes fire rating, integrity and insulation in accordance with the criteria of BS 476: Part 22: 1987.

Door Clear Opening Size:

Door type	Height (mm)	Width (mm)	Fire rating (minutes)
Single leaf Single action	1656 - 2156	462 - 1332	30 or 60
Double leaf Single action	1656 - 2156	1187 - 2312	30 or 60

Components

- (1) Glass thickness - 30 minutes fire rating (T-30): Promat SYSTEMGLASS® 30 - 17mm thick.
Glass thickness - 60 minutes fire rating (T-60): Promat SYSTEMGLASS® 60 - 21mm thick.
- (2) Promat SYSTEMGLASS® door with steel hollow section 60mm x 25mm x 2mm - single or double-leaf door, for 30 and 60 minutes fire rating.
- (3) Promat SYSTEMGLASS® screen in accordance with the details of the Promat SYSTEMGLASS® fire resistant butt jointed glazing system.
- (4) Optional door mid rail.
- (5) Rebate profile, fixed with self-tapping screw or rivet, optionally welded.
- (6) Rubber anti-shock seal or smoke seal.
- (7) Floor or adjacent walls with fire resistance equal to or better than glazing system.
- (8) Dorma 7431K or similar approved hinge and/or floor spring systems.
- (9) Self adhesive ceramic glazing tape, 10mm x 3mm.
- (10) Promat SYSTEMGLASS® silicone mastic.
- (11) Steel hollow section, for screen heights over 3000mm, it is necessary to use a larger profile on the near face of the door frame to provide additional stiffness.
- (12) Optional covering made of stainless steel, aluminium, wood or plastic profiles.

Detail 1 – Elevation

The length of the glazed wall is unlimited, the maximum height is currently restricted to 2700mm. The door can be manufactured with or without a mid rail.

Detail 2 – Silicone joint (Section B-B)

Silicone butt jointing detail to Promat SYSTEMGLASS® screen

Detail 3 – Elevation, alternative screen construction

Promat SYSTEMGLASS® screen in combination with masonry wall to extend the height to a maximum 4000mm.

Detail 4 – Door faming (Section A-A)

Where screen heights exceed 3000mm, the standard framing section is required to be increased in profile on the near face, to provide additional support stiffness.

AUTHORITY: Warrington Bodycote WF Report No. 176591

Technical Data
Sheet – 147

Page 1 of 1
(August 2011)



Promat UK Limited
Customer Relations Team
The Sterling Centre, Eastern Road
Bracknell, Berkshire RG12 2TD
Tel: 01344 381 400
Fax: 01344 381 401
E-mail: technicaluk@promat.co.uk

