

### Promat SYSTEMGLASS® Single & Double Leaf Fire Doors: - Within Masonry Walls.

Promat SYSTEMGLASS® T-doors are constructed without any visible glazing beads on the retaining frame. They can be built as single or double leaf door and incorporated in solid brick or masonry walls. A choice of floor or head mounted closers can be proposed as well as their selected hardware.

30 and 60 minutes fire rating, integrity and insulation in accordance with the criteria of BS 476: Part 22: 1987.

#### Door Clear Opening Size:

Door type	Height (mm)	Width (mm)	Fire rating (minutes)
<b>Single leaf Single action</b>	1656 - 2156	462 - 1332	30 or 60
<b>Double leaf Single action</b>	1656 - 2156	1187 - 2312	30 or 60

#### Components:

- (1) Glass thickness - 30 minutes fire rating (T-30): Promat SYSTEMGLASS® 30 - 17mm thick.  
Glass thickness - 60 minutes fire rating (T-60): Promat SYSTEMGLASS® 60 - 21mm thick.
- (2) Promat SYSTEMGLASS® door with steel hollow section 60mm x 25mm x 2mm - single or double-leaf door, for 30 and 60 minutes fire rating.
- (3) Optional door mid rail.
- (4) Rebate profile, fixed with self-tapping screw or rivet, or optionally welded.
- (5) Rubber anti-shock seal or smoke seal.
- (6) PROMASEAL® PL strip
- (7) Floor or adjacent walls with fire resistance equal to or better than SYSTEMGLASS® T-door.
- (8) Rock wool.
- (9) Masonry fixing, expansion bolt or similar at nominal 500mm centres
- (10) Steel plate.
- (11) Self-closer door control.
- (12) Dorma 7431K or similar approved hinge and/or floor spring systems.

#### Detail 1 – Elevation

Promat SYSTEMGLASS® T-door within a masonry wall. The door may be manufactured with or without a mid rail.

#### Detail 2 – Stop profile

The door frame is made of two steel frames (2), to which a rebated stop profile (4) is fastened. The stop profile also carries the PROMASEAL® PL intumescent strip (6) and seal (5).

#### Detail 3 – Vertical section (Section B-B)

Door leaf construction

#### Detail 4 – Horizontal section (Section A-A)

The door hardware, handles, hinges etc., can be sourced from various manufacturers, but must have certification to prove the suitability for use in Promat SYSTEMGLASS® or similar applications.

NOTE 1: Under no circumstances should the edging tape be removed from the glass. It is there to prevent ingress of moisture or acetate from the silicone sealant entering the intumescent layer and causing discolouration.

NOTE 2: Promat SYSTEMGLASS® is designed for use in internal applications. It should not be used in high humidity, semi exposed or external applications.

NOTE 3: Refer to TDS121 (August 2011) for more details on the Promat SYSTEMGLASS® system.

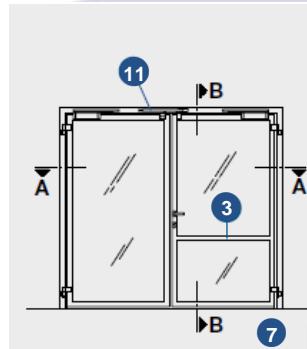

Detail 1 – Elevation

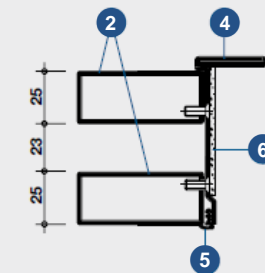

Detail 2 – Stop profile

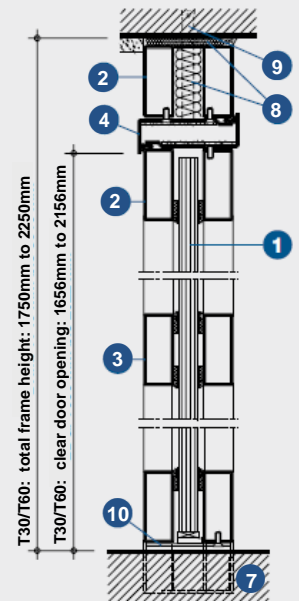

Detail 3 – Vertical section (Section B-B)

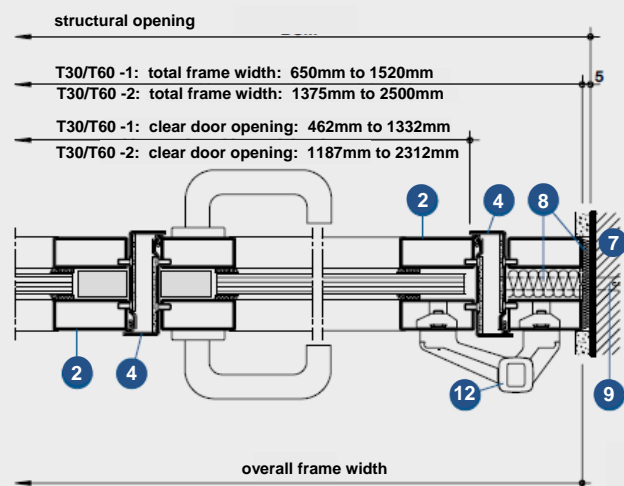

Detail 4 – Horizontal section (Section A-A)

**AUTHORITY:** Promat Recommendation - Based on in-house knowledge and Technical Experience

Technical Data Sheet -149

Page 1 of 1  
(August 2011)



Promat UK Limited  
Customer Relations Team  
The Sterling Centre, Eastern Road  
Bracknell, Berkshire RG12 2TD  
Tel: 01344 381 400  
Fax: 01344 381 401  
E-mail: technicaluk@promat.co.uk

